

Monday through Friday

234/734

Effective Jul 6 2020

Northbound Al Norte (Approximate Times / Tiempos Aproximados)

Route	WEST LOS ANGELES 10	WESTWOOD 9	SHERMAN OAKS 8	VAN NUYS 7	NORTH HILLS 6	MISSION HILLS 5	SAN FERNANDO 4	SYLMAR 3	Eldridge & Harding Mission College 2	Eldridge & Harding Mission College 1
234	5:21A									
734	5:35	5:47A								
734	5:58		6:13							
734	6:24		6:39							
734	6:54		7:09							
734	7:21		7:38							
734	7:49		8:08							
734	8:20		8:39							
734	8:50		9:09							
734	9:20		9:39							
734	9:51		10:09							
734	10:22		10:39							
734	10:52		11:09							
734	11:22		11:39							
734	11:52		12:09P							
734	12:22P		12:39							
734	12:52		1:09							
734	1:21		1:38							
734	1:49		2:06							
734	2:17		2:34							
734	2:30		2:48							
734	2:43		3:01							
734	2:57		3:16							
734	3:10		3:29							
734	3:24		3:43							
734	3:38		3:57							
734	4:07		4:27							
734	4:21		4:42							
734	4:37		4:58							
734	5:09		5:30							
734	5:42		6:03							
734	6:15		6:36							
734	6:53		7:10							
734	7:27		7:44							
734	7:59		8:14							
734	8:30		8:44							
734	9:00	9:12P								
734	9:44	9:58								10:57
734	10:24	10:38								11:26
734	11:04	11:58								12:04A
734	11:44									12:44
734	12:24A	12:38A								
734	1:04	1:18								

Monday through Friday

234/734

Southbound Al Sur (Approximate Times / Tiempos Aproximados)

Route	SYLMAR 1	SAN FERNANDO 2	MISSION HILLS 3	NORTH HILLS 4	VAN NUYS 5	SHERMAN OAKS 6	WESTWOOD 7	WILSHIRE & WESTWOOD 8	WILSHIRE & VETERAN 9	West Los Angeles Expo Station 10
234	4:53A									
734	5:20	4:20A								
734	5:49	4:48								
734	6:16	5:16								
734	6:44	5:45								
734	7:13	6:05								
734	7:42	6:14								
734	8:11	6:18								
734	8:39	6:32								
734	9:09	6:45								
734	9:39	6:58								
734	10:07	7:11								
734	10:35	7:24								
734	11:05	7:40								
734	11:36	7:57								
734	12:06P	8:09								
734	12:36	8:37								
734	1:06	8:48								
734	1:36	9:09								
734	2:06	9:38								
734	2:36	10:08								
734	3:07	10:36								
734	3:36	11:04								
734	4:07	11:33								
734	4:37	12:02P								
734	5:09	12:31								
734	5:40	1:00								
734	6:14	1:29								
734	6:43	1:58								
734	7:05	2:27								
734	7:28	2:56								
734	7:50	3:25								
734	8:12	3:54								
734	8:35	4:23								
734	8:55	4:52								
734	9:35	5:21								
734	10:15	5:50								
734	10:55	6:19								
734	11:35	6:48								

Boxed trips will operate over detour via Veteran and Kinross Ave, in the Westwood area. Between the hours of 9pm to 6am nightly. Refer to map.

Special Notes

- A** Trip originates at Foothill Blvd. & Sayer St. 15-22 minutes before time shown.
- B** Trip terminates at Foothill Blvd. & Sayer St. 13-17 minutes after time shown.
- C** Trip terminates at Harding St. & Eldridge Ave. at time shown.
- D** Trip terminates at Maclay St. & Glenoaks Ave. at time shown.

Avisos especiales

- A** El viaje se origina en Foothill Blvd. & Sayer St. 15-22 minutos antes de la hora mostrada.
- B** El viaje termina en Foothill Blvd. & Sayer St. 13-17 minutos después de la hora mostrada.
- C** El viaje termina en Harding St. & Eldridge Ave. a la hora mostrada.
- D** El viaje termina en Maclay St. & Glenoaks Ave. a la hora mostrada.



Subject to change without notice. Sujeto a cambios sin previo aviso.



Wheelchair Accessible Metro
800.621.7828
California Relay Service
711



Travel Info
511

Sylmar Station - West Los Angeles via Sepulveda Bl

234

734

Metro Local
Sylmar Station - Westwood

Metro Rapid

Effective Jul 6 2020

Northbound Al Norte (Approximate Times / Tiempos Aproximados)

Southbound Al Sur (Approximate Times / Tiempos Aproximados)

Table with 13 columns for stations (West Los Angeles to Sylmar) and 13 columns for stations (Sylmar to West Los Angeles). Rows list departure times for various bus lines (e.g., 5:52A, 6:18, 6:43, etc.) for each station.

Sunday and Holiday

Northbound Al Norte (Approximate Times / Tiempos Aproximados)

Southbound Al Sur (Approximate Times / Tiempos Aproximados)

Table with 13 columns for stations (West Los Angeles to Sylmar) and 13 columns for stations (Sylmar to West Los Angeles). Rows list departure times for various bus lines (e.g., 5:52A, 6:18, 6:43, etc.) for each station.

INSET MAP

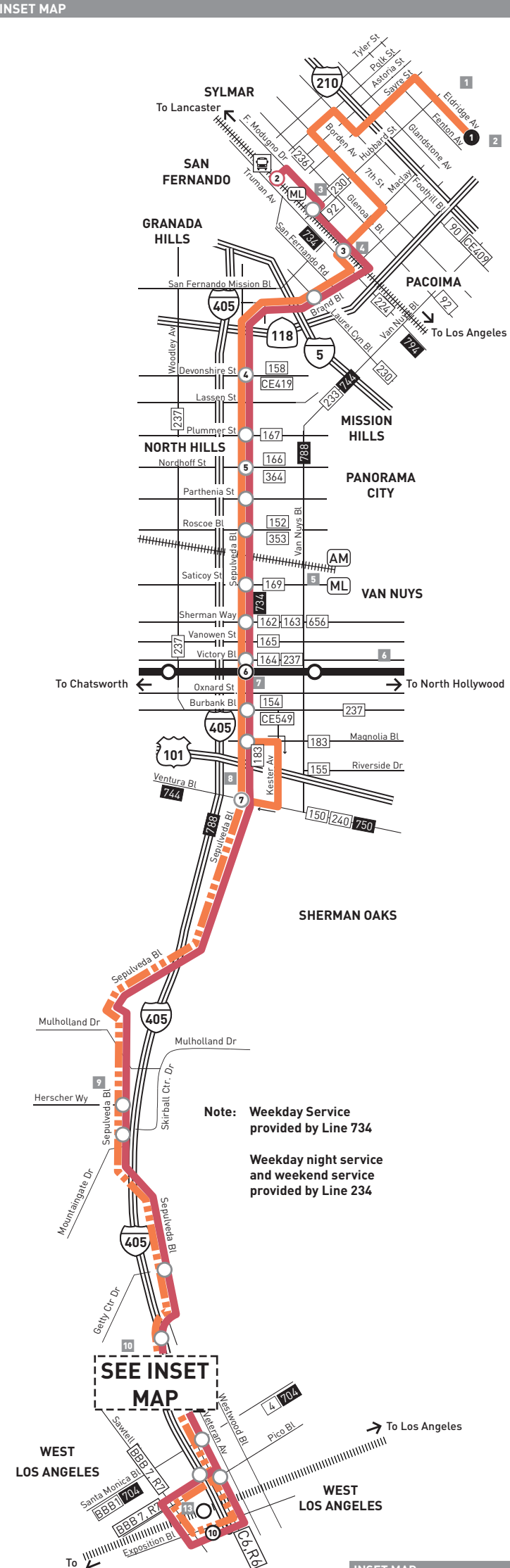

LEGEND section containing symbols and descriptions for Line 234 Route, Weekend/Early Morning & Late Night route, Nightly Detour Segment Stop, Line 734 Route, Metro L Line (Orange), Metro E Line (Expo), Metrolink, Local Stop Timepoint, Night detour segment stops, Rapid and Local Stop Timepoint, Rapid and Local Stop, Rapid Stop Timepoint, Amtrak Station, Metrolink Station, Transit Center, Santa Monica's Big Blue Bus, LADOT Commuter Express, and Culver City Transit.

- MAP NOTES section listing 13 specific locations: 1 Los Angeles Mission College, 2 Los Angeles Mission College East Campus, 3 Sylmar Station, 4 San Fernando Courthouse and City Hall, 5 Van Nuys Metrolink Station, 6 Van Nuys Civic Center, 7 Sepulveda L Line (Orange) Station, 8 Sherman Oaks Galleria, 9 Skirball Cultural Center and Museum, 10 Getty Center Museum, 11 Le Conte Av & Westwood Bl, 12 Federal Building, 13 Expo/Sepulveda E Line (Expo) Station.

