

MAP NOTES

- 1** Larchmont Village
- 2** Pan Pacific Park
- 3** The Grove
- 4** CBS Television City
- 5** Farmer's Market
- 6** Beverly Center
- 7** Cedars-Sinai Medical Center
- 8** Regent Beverly Wilshire Hotel

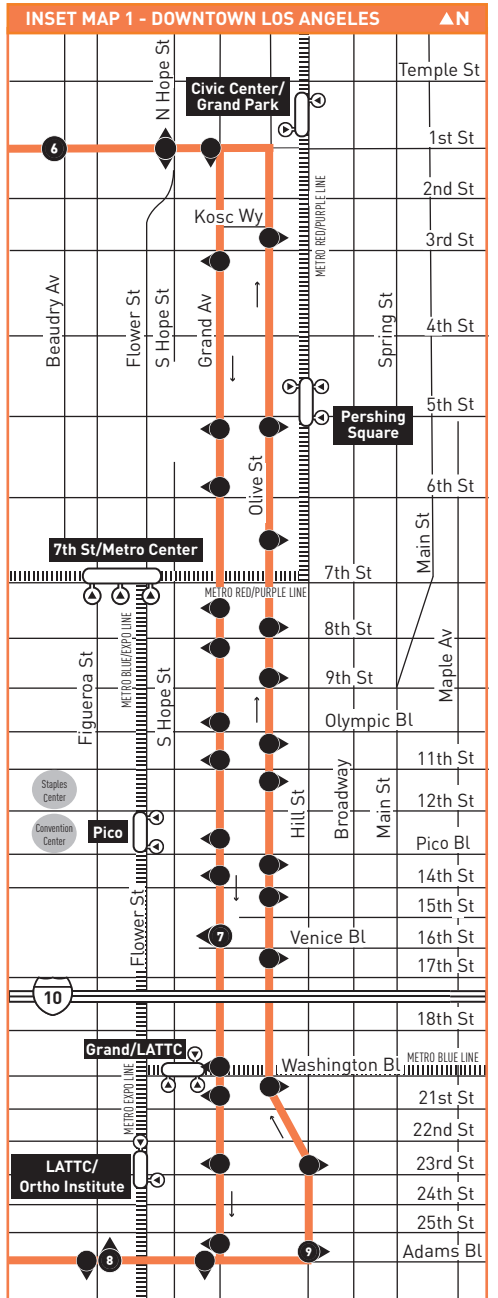

INSET 1 - DOWNTOWN LOS ANGELES

- Line 14 Route
- Shortline Turnaround
- Local Stop
- Local Stop - Single Direction Only
- Local Stop Timepoint
- Local Stop Timepoint - Single Direction Only
- Metro Rail / Busway Station & Timepoint
- Metro Rail
- Metro Rail Station
- Santa Monica's Big Blue Bus
- LADOT DASH

LEGEND

- Line 14 Route
- Shortline Turnaround
- Local Stop
- Local Stop - Single Direction Only
- Local Stop Timepoint
- Local Stop Timepoint - Single Direction Only
- Metro Rail / Busway Station & Timepoint
- Metro Rail
- Metro Rail Station
- Santa Monica's Big Blue Bus
- LADOT DASH

# Monday through Friday

Effective Jun 25 2017

## Eastbound Al Este (Approximate Times / Tiempos Aproximados)

## Westbound Al Oeste (Approximate Times)

BEVERLY HILLS	LOS ANGELES			DOWNTOWN LOS ANGELES			DOWNTOWN LOS ANGELES			LOS ANGELES			BEVERLY HILLS
1	3	4	5	6	7	8	9	6	5	4	2	1	
Beverly & Pico	Beverly & La Cienega	Beverly & La Brea	Vermont / Beverly Station	1st & Broadway	Grand & Venice	Adams & Figueroa	Hill & Adams	1st & Broadway	Vermont / Beverly Station	Beverly & La Brea	San Vicente & Gracie Allen	Beverly & Pico	
—	5:07A	5:13A	5:24A	5:34A	5:45A	5:50A	4:51A	5:06A	5:15A	5:24A	—	5:45A	
5:29A	5:26	5:32	5:44	5:55	6:07	6:15	5:12	5:27	5:38	5:48	—	6:10	
—	5:43	5:49	6:01	6:12	6:25	6:33	5:32	5:47	5:59	6:10	—	6:32	
—	5:53	5:59	6:11	6:22	6:35	6:43	5:46	6:01	6:14	6:25	—	6:49	
—	6:02	6:08	6:20	6:31	6:44	6:52	5:55	6:11	6:24	6:36	—	7:01	
5:56	6:10	6:16	6:28	6:40	6:53	7:01	6:03	6:20	6:33	6:46	6:55A	—	
—	6:18	6:24	6:37	6:49	7:02	7:10	6:10	6:27	6:41	6:54	—	7:22	
—	6:25	6:32	6:45	6:57	7:12	7:20	6:18	6:35	6:49	7:02	7:11	—	
—	6:31	6:38	6:51	7:03	7:18	7:26	6:25	6:42	6:56	7:11	—	7:39	
6:23	6:37	6:44	6:57	7:10	7:25	7:33	6:31	6:49	7:03	7:19	7:28	—	
—	6:43	6:50	7:03	7:17	7:32	7:40	6:38	6:56	7:11	7:27	—	7:58	
—	6:48	6:55	7:09	7:23	7:38	—	6:44	7:02	7:17	7:34	7:46	—	
—	6:53	7:00	7:15	7:29	7:44	7:52	6:49	7:08	7:23	7:41	7:52	—	
6:44	6:58	7:05	7:20	7:34	7:49	—	6:54	7:13	7:28	7:48	—	8:20	
—	7:02	7:09	7:24	7:39	7:54	8:02	7:00	7:19	7:34	7:54	8:07	—	
—	7:06	7:13	7:28	7:44	7:59	—	7:05	7:24	7:39	7:59	8:13	—	
—	7:11	7:18	7:33	7:49	8:04	8:12	7:10	7:29	7:44	8:04	—	8:38	
6:59	7:15	7:22	7:37	7:53	8:09	—	7:15	7:34	7:49	8:09	8:23	—	
—	7:18	7:25	7:41	7:57	8:13	8:21	7:20	7:39	7:54	8:14	8:28	—	
—	7:22	7:29	7:45	8:01	8:17	—	7:25	7:44	7:59	8:19	8:37	8:53	
7:10	7:27	7:34	7:50	8:06	8:22	8:30	7:30	7:49	8:04	8:24	8:38	—	
—	7:32	7:40	7:56	8:11	8:27	—	7:35	7:54	8:08	8:28	8:41	—	
7:22	7:39	7:47	8:03	8:18	8:34	8:42	7:40	7:59	8:13	8:33	—	9:08	
—	7:46	7:54	8:10	8:25	8:41	8:49	7:46	8:05	8:19	8:39	8:53	—	
7:38	7:56	8:05	8:21	8:36	8:52	9:00	7:52	8:11	8:25	8:45	8:59	—	
—	8:08	8:17	8:33	8:47	9:03	9:11	7:59	8:18	8:32	8:51	—	9:26	
8:01	8:19	8:28	8:44	8:58	9:14	9:22	8:06	8:25	8:39	8:58	—	9:12	
—	8:30	8:39	8:55	9:09	9:25	9:33	8:13	8:32	8:46	9:04	9:18	—	
—	8:41	8:50	9:06	9:20	9:36	9:44	8:20	8:39	8:53	9:11	—	9:45	
8:35	8:54	9:03	9:19	9:33	9:49	9:57	8:27	8:46	9:00	9:18	9:32	—	
—	9:08	9:17	9:33	9:47	10:03	10:11	8:35	8:54	9:08	9:26	9:39	—	
—	9:24	9:33	9:48	10:02	10:18	10:26	8:43	9:02	9:16	9:34	—	10:05	
9:21	9:40	9:50	10:05	10:18	10:34	10:42	8:51	9:10	9:24	9:41	9:53	—	
—	9:55	10:05	10:20	10:33	10:49	10:57	9:02	9:21	9:35	9:51	10:03	—	
—	10:10	10:20	10:35	10:48	11:04	11:12	9:11	9:30	9:44	10:00	—	10:31	
10:05	10:25	10:35	10:50	11:03	11:19	11:27	9:21	9:40	9:54	10:10	10:21	—	
—	10:40	10:50	11:05	11:18	11:34	11:42	9:32	9:51	10:05	10:21	10:32	—	
—	10:55	11:05	11:20	11:33	11:49	11:57	9:42	10:01	10:15	10:31	—	11:04	
10:50	11:10	11:20	11:35	11:48	12:04	12:12	9:53	10:12	10:26	10:42	10:53	—	
—	11:24	11:34	11:50	12:03P	12:19	12:28	10:05	10:24	10:38	10:54	—	11:27	
—	11:39	11:49	12:05P	12:18	12:34	12:43	10:18	10:37	10:51	11:07	11:18	—	
11:32	11:53	12:03P	12:19	12:32	12:48	12:57	10:31	10:50	11:04	11:20	—	11:53	
—	12:05P	12:16	12:32	12:45	1:01	1:10	10:46	11:05	11:19	11:35	11:47	—	
12:08P	12:18	12:29	12:45	12:58	1:14	1:23	11:02	11:21	11:35	11:51	—	12:25P	
—	12:30	12:42	12:58	1:11	1:27	1:36	11:17	11:36	11:50	12:06P	12:19P	—	
—	12:42	12:54	1:10	1:23	1:39	1:48	11:33	11:52	12:06P	12:22	—	12:56	
—	12:53	1:06	1:22	1:35	1:51	2:00	11:48	12:07P	12:21	12:37	12:50	—	
12:43	1:05	1:18	1:34	1:47	2:03	2:12	12:03P	12:22	12:36	12:52	—	1:28	
—	1:17	1:30	1:46	1:59	2:15	2:24	12:18	12:37	12:51	1:07	1:20	—	
—	1:28	1:42	1:58	2:11	2:27	2:36	12:32	12:51	1:05	1:21	—	1:57	
1:15	1:37	1:51	2:07	2:20	2:36	2:45	12:47	1:06	1:20	1:36	1:49	—	
—	1:45	1:59	2:15	2:28	2:44	2:53	1:01	1:20	1:34	1:50	—	2:26	
—	1:52	2:07	2:23	2:36	2:52	3:01	1:16	1:35	1:49	2:05	—	2:18	
1:37	2:00	2:15	2:31	2:44	3:00	3:09	1:28	1:47	2:01	2:17	—	2:53	
—	2:07	2:22	2:39	2:52	3:08	3:17	1:43	2:02	2:16	2:32	2:45	—	
—	2:14	2:29	2:47	3:00	3:16	3:25	1:56	2:16	2:30	2:46	—	3:21	
1:58	2:21	2:36	2:54	3:08	3:24	3:33	2:08	2:28	2:42	2:58	3:10	—	
—	2:29	2:44	3:02	3:16	3:32	3:41	2:19	2:39	2:53	3:09	3:21	—	
—	2:36	2:51	3:10	3:24	3:40	3:49	2:30	2:50	3:04	3:20	—	3:55	
2:20	2:44	2:59	3:18	3:32	3:48	3:57	2:41	3:01	3:15	3:31	3:43	—	
—	2:51	3:07	3:26	3:40	3:56	4:05	2:49	3:10	3:24	3:40	3:52	—	
—	2:59	3:15	3:34	3:48	4:04	4:13	2:57	3:18	3:32	3:48	4:00	—	
2:41	3:06	3:22	3:41	3:55	4:12	4:21	3:05	3:26	3:40	3:56	—	4:29	
—	3:15	3:31	3:50	4:04	4:21	4:30	3:12	3:33	3:47	4:03	4:14	—	
—	3:23	3:39	3:58	4:12	4:29	4:39	3:19	3:40	3:54	4:10	4:21	—	
3:06	3:31	3:47	4:06	4:20	4:37	4:47	3:25	3:46	4:00	4:16	4:27	—	
—	3:37	3:54	4:14	4:28	4:46	4:56	3:31	3:52	4:06	4:22	—	4:55	
—	3:45	4:02	4:22	4:36	4:54	5:04	3:37	3:58	4:12	4:28	4:39	—	
—	3:51	4:08	4:28	4:42	5:00	5:11	3:43	4:04	4:18	4:34	4:45	—	
3:34	4:00	4:17	4:37	4:51	5:10	5:21	3:49	4:10	4:24	4:40	4:51	—	
—	4:07	4:24	4:44	4:58	5:17	5:28	3:55	4:16	4:30	4:46	—	5:19	
—	4:13	4:30	4:50	5:04	5:23	5:34	4:01	4:22	4:36	4:52	5:03	—	
—	4:19	4:36	4:56	5:10	5:29	5:40	4:08	4:29	4:43	4:59	5:10	—	
3:59	4:25	4:42	5:02	5:16	5:35	5:46	4:14	4:35	4:49	5:05	—	5:38	
—	4:31	4:48	5:08	5:22	5:40	5:51	4:22	4:44	4:58	5:15	5:24	—	
—	4:36	4:53	5:14	5:28	5:46	5:57	4:29	4:52	5:06	5:23	5:32	—	
—	4:42	4:59	5:20	5:34	5:52	6:03	4:37	5:00	5:15	5:32	5:43	—	
4:21	4:48	5:05	5:26	5:40	5:58	6:08	4:45	5:08	5:23	5:40	—	6:12	
—	4:54	5:11	5:32	5:46	6:04	6:14	4:53	5:16	5:31	5:48	5:57	—	
—	5:01	5:18	5:39	5:53	6:10	6:20	5:01	5:24	5:39	5:56	6:06	—	
—	5:08	5:25	5:46	6:00	6:16	6:26	5:09	5:32	5:47	6:04	—	6:35	
4:49	5:16	5:33	5:54	6:08	6:24	6:34	5:17	5:40	5:55	6:12	6:22	—	
—	5:24	5:41	6:02	6:16	6:32	6:41	5:25	5:48	6:03	6:20	6:29	—	
—	5:34	5:51	6:12	6:26	6:41	6:50	5:34	5:57	6:12	6:29	—	7:00	
5:21	5:48	6:05	6:26	6:39	6:53	7:02	5:43	6:06	6:21	6:37	6:47	—	
—	6:01	6:17	6:38	6:51	7:05	7:13	5:55	6:17	6:32	6:47	6:56	—	
5:53	6:19	6:34	6:54	7:06	7:19	7:27	6:06	6:28	6:42	6:57	—	7:25	
—	6:35	6:49	7:08	7:20	7:33	7:39	6:20	6:42	6:56	7:10	7:20	—	
6:27	6:50	7:04	7:22	7:34	7:46	7:52	6:35	6:56	7:10	7:23	7:32	—	
—	7:06	7:20	7:37	7:48	8:00	8:06	6:56	7:15	7:29	7:41	—	8:08	
6:58	7:20	7:33	7:49	8:00	8:11	8:17	7:18	7:35	7:48	8:00	8:09	—	
—	7:38	7:50	8:06	8:17	8:28	8:34	7:37	7:54	8:07	8:19	—	8:46	
7:40	8:00	8:10	8:26	8:37	8:47	8:53	8:06	8:22	8:35	8:47	—	9:13	
8:20	8:38	8:48	9:02	9:13	9:28	9:34	8:36	8:52	9:05	9:16	9:23	—	
9:08	9:26	9:35	9:49	10:00	10:15	10:20	8:57	9:18	9:30	9:41	—	10:04	
10:15	10:29	10:37	10:49	10:59	11:14	11:19	9:08	9:19	10:31	10:41	—	11:03	
11:17	11:31	11:38	11:50	11:59	12:14A	12:19A	9:58	11:19	11:29	11:38	—	11:59	
12:19A	12:33A	12:39A	12:50A	12:59A	1:14	1:19	11:58	12:19A	12:29A	12:38A	12:44A	—	
—	—	—	1:50	1:59	2:14	2:19	11:58A	1:19					

**Eastbound Al Este** (Approximate Times / *Tiempos Aproximados*)

**Westbound Al Oeste** (Approximate Times)

BEVERLY HILLS	LOS ANGELES			DOWNTOWN LOS ANGELES			DOWNTOWN LOS ANGELES	LOS ANGELES			BEVERLY HILLS	
1	3	4	5	6	7	8	9	6	5	4	2	1
Beverly & Pico	Beverly & La Cienega	Beverly & La Brea	Vermont / Beverly Station	1st & Beaudry	Grand & Venice	Adams & Figueroa	Hill & Adams	1st & Beaudry	Vermont / Beverly Station	Beverly & La Brea	San Vicente & Gracie Allen	Beverly & Pico
—	5:12A	5:18A	5:29A	5:38A	5:48A	5:53A	5:00A	5:15A	5:25A	5:35A	—	5:57A
5:45A	5:36	5:42	5:53	6:03	6:13	6:19	5:38	5:53	6:05	6:15	—	6:39
6:10	6:00	6:07	6:19	6:30	6:42	6:48	6:00	6:16	6:28	6:40	—	7:04
—	6:25	6:32	6:44	6:55	7:07	7:14	6:19	6:35	6:48	7:00	7:10A	—
6:55	6:46	6:53	7:06	7:18	7:30	7:37	6:35	6:52	7:05	7:17	—	7:41
7:17	7:10	7:17	7:31	7:43	7:55	8:02	6:50	7:08	7:21	7:33	7:44	—
—	7:32	7:41	7:55	8:07	8:21	8:28	7:08	7:26	7:39	7:52	—	8:18
7:58	7:53	8:02	8:16	8:28	8:42	8:49	7:22	7:41	7:55	8:08	8:19	—
—	8:13	8:22	8:36	8:49	9:03	9:10	7:42	8:01	8:15	8:29	—	8:55
8:39	8:34	8:43	8:58	9:11	9:25	9:32	7:59	8:19	8:33	8:47	8:58	—
—	8:54	9:03	9:18	9:31	9:45	9:53	8:16	8:36	8:51	9:05	—	9:33
9:19	9:14	9:23	9:38	9:51	10:05	10:13	8:33	8:53	9:08	9:23	9:35	—
—	9:34	9:43	9:58	10:11	10:25	10:33	8:48	9:08	9:23	9:38	—	10:08
9:55	9:53	10:02	10:18	10:31	10:45	10:53	9:03	9:23	9:38	9:53	10:06	—
—	10:12	10:22	10:38	10:51	11:05	11:13	9:18	9:38	9:53	10:08	—	10:38
10:33	10:32	10:42	10:58	11:11	11:26	11:34	9:33	9:53	10:07	10:22	10:35	—
—	10:51	11:01	11:18	11:31	11:46	11:54	9:48	10:08	10:21	10:36	—	11:07
11:12	11:11	11:21	11:38	11:51	12:06P	12:14P	10:01	10:21	10:34	10:49	10:59	—
—	11:30	11:41	11:58	12:11P	12:26	12:34	10:14	10:34	10:47	11:02	—	11:34
11:49	11:49	11:59	12:17P	12:30	12:45	12:53	10:29	10:49	11:02	11:17	11:30	—
—	12:07P	12:19P	12:36	12:48	1:03	1:11	10:45	11:05	11:18	11:33	—	12:06P
12:26P	12:25	12:37	12:55	1:07	1:22	1:30	11:01	11:21	11:34	11:49	12:04P	—
—	12:44	12:56	1:14	1:26	1:42	1:50	11:16	11:36	11:49	12:04P	—	12:37
1:00	1:01	1:14	1:32	1:44	2:00	2:08	11:32	11:52	12:05P	12:20	12:35	—
—	1:19	1:32	1:50	2:02	2:18	2:26	11:48	12:08P	12:21	12:36	—	1:11
1:31	1:35	1:49	2:07	2:19	2:35	2:43	12:04P	12:24	12:37	12:52	1:07	—
—	1:52	2:06	2:24	2:36	2:52	3:00	12:20	12:40	12:53	1:08	—	1:44
2:02	2:08	2:23	2:41	2:53	3:09	3:17	12:36	12:56	1:09	1:24	1:39	—
—	2:23	2:38	2:56	3:08	3:24	3:32	12:51	1:11	1:24	1:40	—	2:16
2:31	2:37	2:53	3:11	3:23	3:38	3:46	1:08	1:28	1:41	1:57	2:12	—
—	2:52	3:08	3:26	3:38	3:53	4:01	1:23	1:43	1:56	2:12	—	2:47
3:02	3:07	3:23	3:41	3:53	4:08	4:16	1:40	2:00	2:13	2:29	2:44	—
—	3:23	3:39	3:57	4:09	4:24	4:32	1:56	2:16	2:29	2:45	—	3:20
3:37	3:40	3:56	4:14	4:26	4:40	4:48	2:14	2:34	2:47	3:03	3:18	—
—	3:58	4:13	4:31	4:43	4:56	5:04	2:32	2:52	3:05	3:21	—	3:54
4:11	4:15	4:30	4:48	5:00	5:13	5:20	2:50	3:10	3:23	3:39	3:54	—
—	4:32	4:47	5:05	5:17	5:30	5:37	3:09	3:29	3:42	3:58	—	4:30
4:44	4:47	5:02	5:20	5:32	5:45	5:52	3:27	3:47	4:00	4:16	4:31	—
—	5:05	5:19	5:37	5:49	6:02	6:09	3:45	4:05	4:18	4:34	—	5:05
5:18	5:22	5:36	5:54	6:06	6:19	6:26	4:04	4:23	4:36	4:52	5:07	—
—	5:39	5:53	6:11	6:23	6:36	6:43	4:22	4:41	4:54	5:10	—	5:40
5:55	5:57	6:10	6:28	6:40	6:53	7:00	4:40	4:59	5:12	5:28	5:41	—
—	6:16	6:29	6:47	6:59	7:12	7:19	4:58	5:17	5:30	5:46	—	6:15
6:40	6:37	6:50	7:08	7:21	7:34	7:40	5:16	5:35	5:48	6:04	6:17	—
7:09	7:01	7:14	7:31	7:44	7:57	8:03	5:37	5:55	6:08	6:22	—	6:50
—	7:29	7:40	7:57	8:10	8:22	8:28	5:57	6:15	6:28	6:42	—	—
7:41	8:00	8:10	8:25	8:37	8:49	8:55	6:19	6:37	6:49	7:02	—	7:29
8:11	8:28	8:38	8:53	9:05	9:20	9:26	6:52	7:09	7:21	7:34	—	—
9:12	9:28	9:37	9:51	10:02	10:17	10:22	7:24	7:41	7:53	8:05	—	8:31
10:15	10:29	10:37	10:49	10:59	11:14	11:19	7:55	8:12	8:24	8:36	—	9:02
11:17	11:31	11:38	11:50	11:59	12:14A	12:19A	8:27	8:44	8:56	9:07	—	9:31
12:19A	12:33A	12:39A	12:50A	12:59A	1:14	1:19	8:58	9:19	9:31	9:42	—	10:05
—	—	—	1:150	1:159	2:14	2:19	9:58	10:19	10:31	10:41	—	11:03
—	—	—	1:250	1:259	3:14	3:19	10:58	11:19	11:29	11:38	—	11:59
—	—	—	1:350	1:359	4:14	4:19	11:58	12:19A	12:29A	12:38A	—	—
—	—	—	1:450	4:59	5:09	5:14	12:58A	1:19	1:29A	—	—	—
—	—	—	—	—	—	—	1:58	2:19	2:29	—	—	—
—	—	—	—	—	—	—	2:58	3:19	3:29	—	—	—
—	—	—	—	—	—	—	3:58	4:19	4:29	—	—	—

**Sunday and Holiday Schedules**

Sunday & Holiday schedule in effect on New Year's Day, Memorial Day, Independence Day, Labor Day, Thanksgiving Day and Christmas Day.

**Nextrip**

Text "metro" and your intersection or stop number to 41411 (example: metro vignes&cesarechavez or metro 1563). You can also visit [m.metro.net](http://m.metro.net) or call 511 and say "Nextrip"

**Special Notes**

- B** Trips departing 1st & Beaudry change to Line 37.
- C** Trips departing Hill & Adams originate from Line 37.
- D** Trip originates at Santa Monica & Canon 5-8 minutes before time shown.
- E** Trip waits at Grand & 7th for transfer connections.
- F** Trip terminates at Santa Monica & Canon 13 minutes after time shown.
- G** Owl schedule trips departing Hill & Adams originate from the Line 37/38 special loop. See timetable for Line 37 or 38 for more information.
- H** Trip waits at Olive & 7th for transfer connections.
- I** Trip originates from Beverly & Western 5-6 minutes before time shown.
- J** Trip terminates at Beverly & Western 6 minutes after time shown.
- K** Trip terminates at Beverly & La Cienega at time shown.

**Horarios de domingo y días feriados**

Horarios de domingo y días feriados en vigor para New Year's Day, Memorial Day, Independence Day, Labor Day, Thanksgiving Day y Christmas Day.

**Nextrip**

Envíe un mensaje de texto con "Metro" y la intersección de la calle o el número de su parada al 41411. Nextrip le enviará un mensaje de texto con la próxima llegada de cada autobús en esa parada. También puede visitar [m.metro.net](http://m.metro.net) o llamar al 511 y decir "Nextrip"

**Avisos especiales**

- B** Los viajes que salen de la 1st y Beaudry cambian a la Línea 37.
- C** Los viajes que salen de Hill y Adams se originan de la Línea 37.
- D** Viaje comienza en Santa Monica y Canon 5-8 minutos antes de la hora mostrada.
- E** El viaje espera en la Grand y 7th para las conexiones de transferencia.
- F** Viaje termina en Santa Monica y Canon 13 minutos después de la hora mostrada.
- G** Viajes Owl saliendo de Hill y Adams comienzan del servicio especial de Línea 37/38. Favor de ver el horario de Línea 37 ó 38 para más información.
- H** El viaje espera en la Olive y 7th para las conexiones de transferencia.
- I** Viaje comienza en Beverly y Western 5-6 minutos antes de la hora mostrada.
- J** Viaje termina en Beverly y Western 6 minutos después de la hora mostrada.
- K** Viaje termina en Beverly y La Cienega a la hora mostrada.

# Sunday and Holiday Schedule

# 14

Effective Jun 25 2017

## Eastbound Al Este (Approximate Times / Tiempos Aproximados)

## Westbound Al Oeste (Approximate Times)

BEVERLY HILLS	LOS ANGELES			DOWNTOWN LOS ANGELES			DOWNTOWN LOS ANGELES		LOS ANGELES			BEVERLY HILLS
1	3	4	5	6	7	8	9	6	5	4	2	1
Beverly & Pico	Beverly & La Cienega	Beverly & La Brea	Vermont / Beverly Station	1st & Beverly	Grand & Venice	Adams & Figueroa	Hill & Adams	1st & Beverly	Vermont / Beverly Station	Beverly & La Brea	San Vicente & Gracie Allen	Beverly & Pico
—	5:13A	5:19A	5:30A	5:39A	5:49A	5:54A	5:02A	5:15A	5:24A	5:34A	—	5:55A
—	5:51	5:57	6:08	6:18	6:28	6:33	5:51	6:05	6:16	6:26	—	6:48
6:13A	6:29	6:35	6:46	6:56	7:07	7:13	6:25	6:39	6:50	7:00	—	7:22
—	7:01	7:08	7:20	7:31	7:43	7:49	6:55	7:11	7:22	7:33	—	7:56
7:07	7:23	7:30	7:44	7:57	8:10	8:17	7:15	7:31	7:43	7:55	—	8:18
7:31	7:47	7:54	8:08	8:21	8:34	8:41	7:35	7:51	8:03	8:15	—	8:38
—	8:08	8:15	8:29	8:42	8:55	9:02	7:59	8:15	8:27	8:39	—	9:03
8:12	8:28	8:35	8:49	9:02	9:15	9:22	8:20	8:36	8:48	9:00	9:11A	—
8:31	8:48	8:55	9:09	9:22	9:35	9:42	8:38	8:55	9:08	9:21	—	9:47
8:50	9:07	9:15	9:29	9:42	9:55	10:02	8:57	9:14	9:27	9:41	9:52	—
—	9:26	9:35	9:49	10:02	10:15	10:22	9:16	9:33	9:46	10:00	—	10:27
9:27	9:45	9:54	10:09	10:22	10:35	10:42	9:35	9:52	10:05	10:19	10:30	—
—	10:05	10:14	10:29	10:42	10:55	11:02	9:55	10:12	10:25	10:39	—	11:06
10:05	10:23	10:32	10:47	11:00	11:14	11:21	10:14	10:31	10:44	10:58	11:09	—
—	10:44	10:53	11:07	11:19	11:33	11:40	10:32	10:50	11:03	11:17	—	11:44
10:45	11:03	11:12	11:26	11:38	11:52	11:59	10:49	11:07	11:20	11:34	11:45	—
—	11:22	11:31	11:45	11:57	12:10P	12:17P	11:07	11:25	11:38	11:52	—	12:19P
11:21	11:40	11:50	12:04P	12:16P	12:29	12:36	11:25	11:43	11:56	12:10P	12:21P	—
—	11:58	12:08P	12:23	12:35	12:48	12:55	11:43	12:01P	12:14P	12:28	—	12:55
11:58	12:17P	12:27	12:42	12:54	1:07	1:14	12:01P	12:19	12:32	12:46	12:57	—
—	12:36	12:46	1:01	1:13	1:26	1:33	12:19	12:37	12:50	1:04	—	1:33
12:35P	12:54	1:04	1:20	1:32	1:45	1:52	12:37	12:55	1:08	1:22	1:33	—
—	1:13	1:24	1:40	1:52	2:05	2:12	12:55	1:13	1:26	1:41	—	2:11
1:11	1:31	1:42	1:58	2:10	2:23	2:30	1:13	1:31	1:44	1:59	2:11	—
—	1:49	2:00	2:16	2:28	2:41	2:48	1:31	1:49	2:02	2:17	—	2:47
1:46	2:06	2:18	2:34	2:46	2:59	3:06	1:49	2:07	2:20	2:35	2:47	—
—	2:24	2:36	2:52	3:04	3:17	3:24	2:07	2:25	2:38	2:53	—	3:23
2:22	2:42	2:54	3:10	3:22	3:35	3:42	2:26	2:44	2:57	3:12	3:24	—
—	3:00	3:12	3:28	3:40	3:53	4:00	2:45	3:03	3:16	3:31	—	4:01
2:59	3:19	3:31	3:46	3:58	4:11	4:18	3:05	3:23	3:36	3:51	4:02	—
—	3:36	3:49	4:04	4:16	4:29	4:36	3:25	3:43	3:56	4:11	—	4:40
3:36	3:55	4:08	4:23	4:35	4:48	4:55	3:45	4:03	4:16	4:31	4:41	—
—	4:15	4:28	4:43	4:54	5:07	5:13	4:05	4:23	4:36	4:51	—	5:19
4:14	4:33	4:46	5:01	5:12	5:25	5:31	4:25	4:43	4:56	5:10	5:20	—
—	4:54	5:06	5:21	5:32	5:45	5:51	4:45	5:03	5:16	5:29	—	5:56
4:54	5:13	5:25	5:40	5:52	6:05	6:11	5:08	5:25	5:38	5:51	6:01	—
—	5:33	5:45	6:00	6:12	6:24	6:30	5:30	5:47	6:00	6:13	—	6:40
5:34	5:53	6:05	6:20	6:32	6:44	6:50	5:50	6:07	6:20	6:33	—	7:00
—	6:18	6:29	6:43	6:54	7:06	7:12	6:13	6:30	6:42	6:55	—	7:22
6:24	6:43	6:54	7:08	7:19	7:31	7:37	6:38	6:55	7:07	7:18	—	7:45
6:51	7:09	7:19	7:33	7:44	7:55	8:01	7:04	7:20	7:32	7:43	—	8:09
7:17	7:34	7:44	7:58	8:09	8:20	8:26	7:33	7:49	8:01	8:12	—	8:38
7:42	7:59	8:09	8:23	8:34	8:44	8:50	8:03	8:19	8:31	8:42	—	9:08
8:07	8:24	8:34	8:48	8:59	9:14	9:20	8:58	9:19	9:31	9:42	—	10:05
9:08	9:24	9:34	9:48	9:59	10:14	10:19	9:58	10:19	10:31	10:41	—	11:03
10:15	10:29	10:37	10:49	10:59	11:14	11:19	10:58	11:19	11:29	11:38	—	11:59
11:17	11:31	11:38	11:50	11:59	12:14A	12:19A	11:58	12:19A	12:29A	12:38A	—	—
12:19A	12:33A	12:39A	12:50A	12:59A	1:14	1:19	12:58A	1:19	1:29	—	—	—
—	—	—	1:50	1:59	2:14	2:19	1:58	2:19	2:29	—	—	—
—	—	—	2:50	2:59	3:14	3:19	2:58	3:19	3:29	—	—	—
—	—	—	3:50	3:59	4:14	4:19	3:58	4:19	4:29	—	—	—
—	—	—	4:50	4:59	5:09	5:14	—	—	—	—	—	—