

Westside Subway Extension Project Definition for Phases 2 and 3

Board of Directors

May 24, 2012

Final EIS/EIR Released March 19, 2012

Recommended Alignment & Station Locations

- 9 Mile Extension from Wilshire-Western Station to Westwood-VA Hospital
- Daily Ridership at 7 new stations:
 - 49,300 boardings
 - 78,700 project trips
- 25 minute 1-way travel time between Downtown Los Angeles & Westwood
- \$5.6 billion (\$2022)

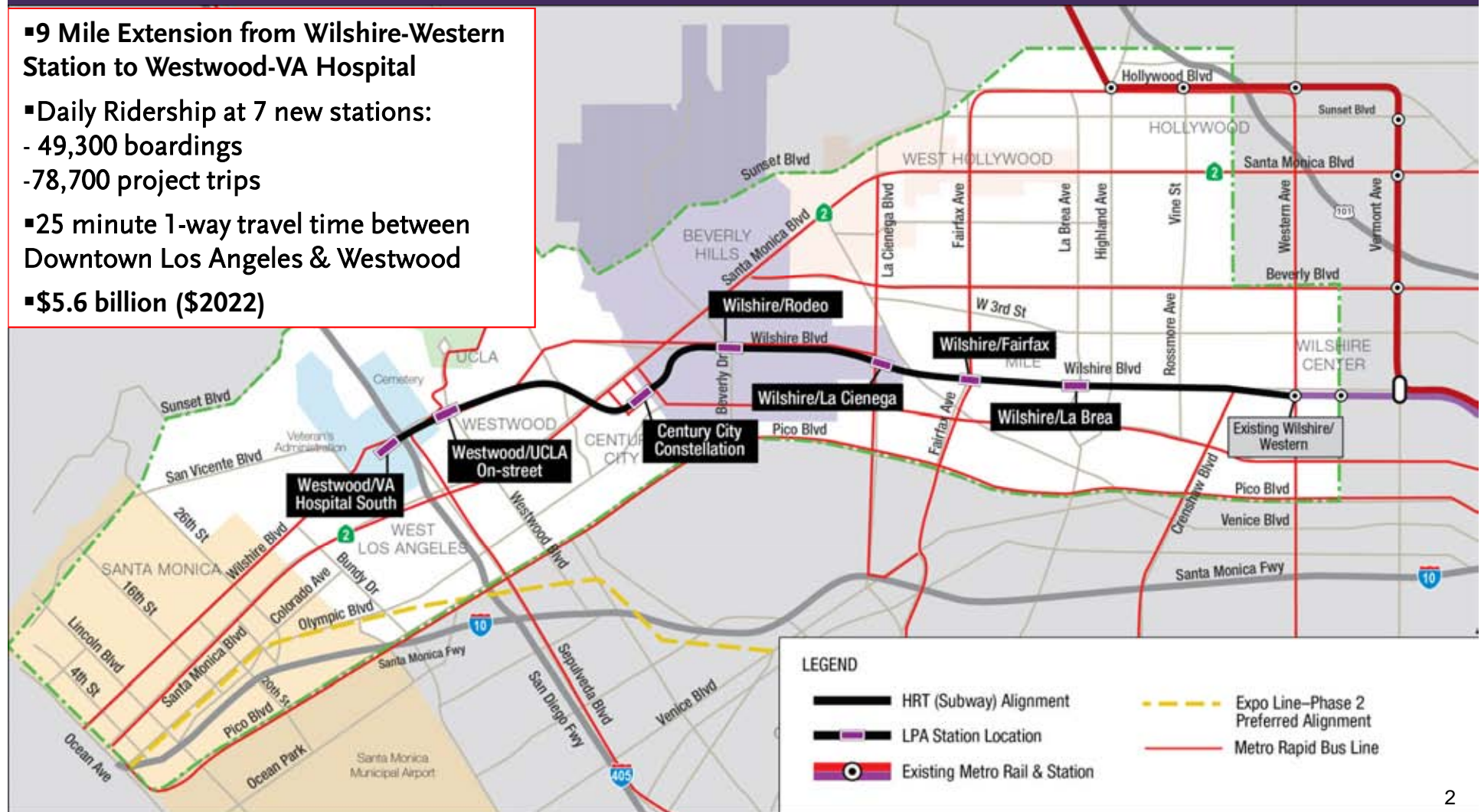

Phase 2 and 3 FEIS/FEIR Recommendations

1. Station Locations and Alignments

- Century City
- Westwood/UCLA
- Westwood/VA Hospital

2. Station Entrance and Construction Staging Sites

- Wilshire/Rodeo
- Century City/Constellation
- Westwood/UCLA
- Westwood/VA Hospital

Project Phases

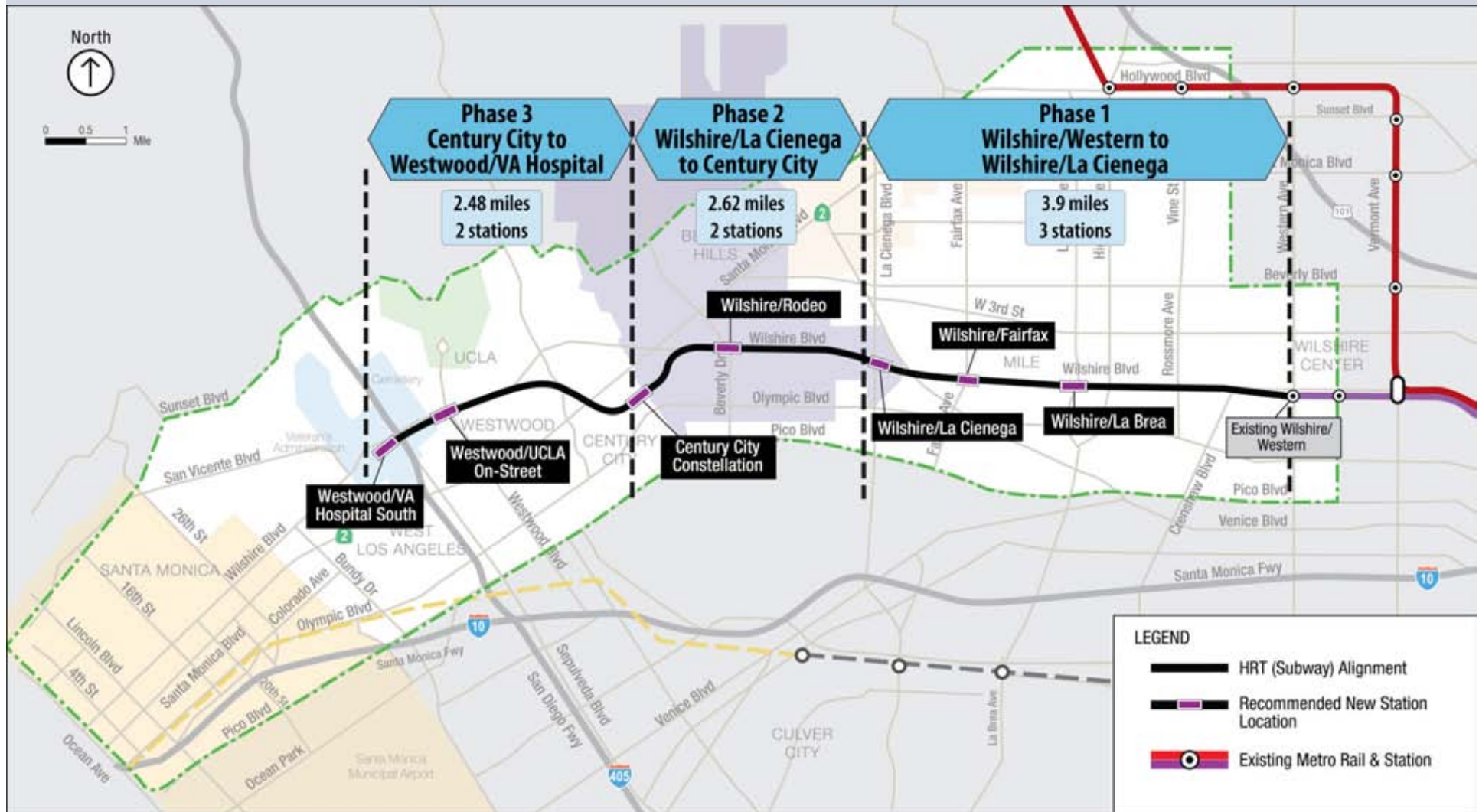

1a) Century City Alignment and Station Location

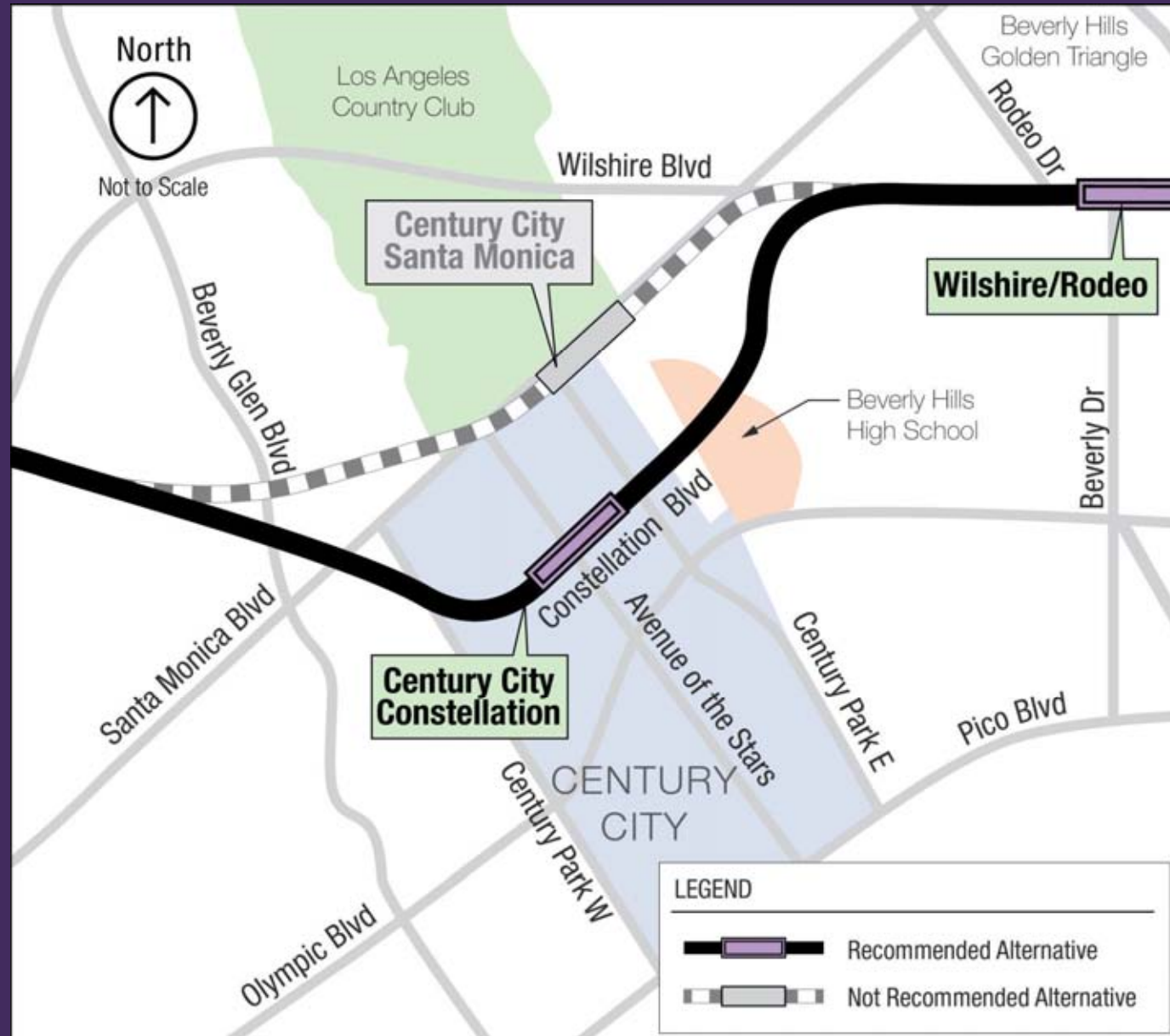

1a) Century City Station and Alignment

- Reasons for Recommendation
 - Seismic and Geotechnical Safety
 - Risks for tunnel alignment in Beverly Hills have been addressed:
 - Risk of Settlement
 - Noise and Vibration
 - Risk from Gassy Ground and Oil Wells
 - Tunneling through Fault Zones
 - Use of Beverly Hills High School as a Emergency Evacuation Center
 - Impacts to Future Plans to Remodel and Expand Beverly Hills H.S.
 - Overall Risks to Students, Faculty and Community
 - Higher Ridership

1b and 1c) Westwood/UCLA and Westwood/VA Hospital Alignment and Station Recommendations



1b and 1c) Westwood/UCLA and Westwood/VA Hospital Alignments and Station Locations

- Westwood/UCLA Station Recommendation
 - Under Wilshire Boulevard between Westwood & Gayley
 - Easier to construct, fewer impacts to existing buildings
 - Only station requiring 2 entrances due to boardings
 - One at UCLA Lot 36
 - One “split” entrance on the west side of the Wilshire/Westwood intersection
- Westwood/VA Hospital Station Recommendation
 - South side of Wilshire at Bonsall
 - Less expensive location
 - Closer to hospital entrance
 - Better position for any future extension

2a) Wilshire/Rodeo Station

- Recommended entrance & construction staging at SW corner Wilshire/Reeves
- Too many impacts for entrance options closer to Beverly & Rodeo
- NE corner Wilshire/Canon also needed for construction staging

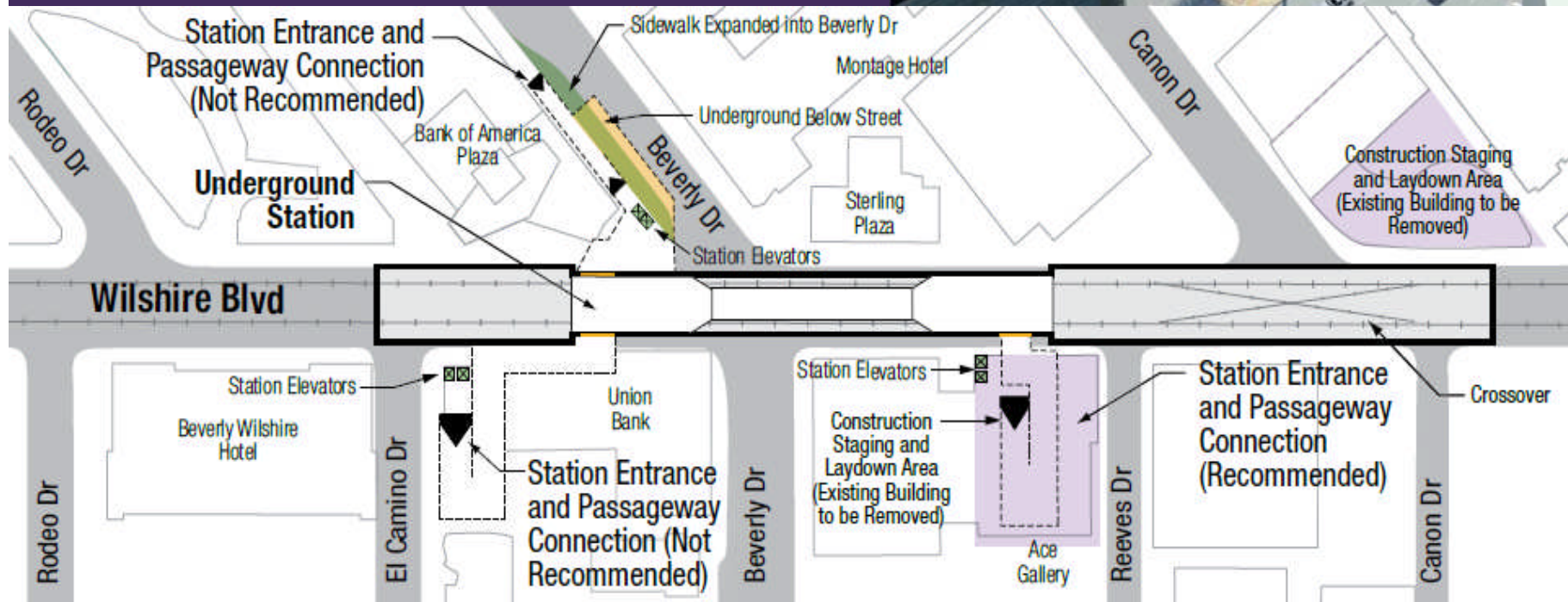

2b) Century City Station

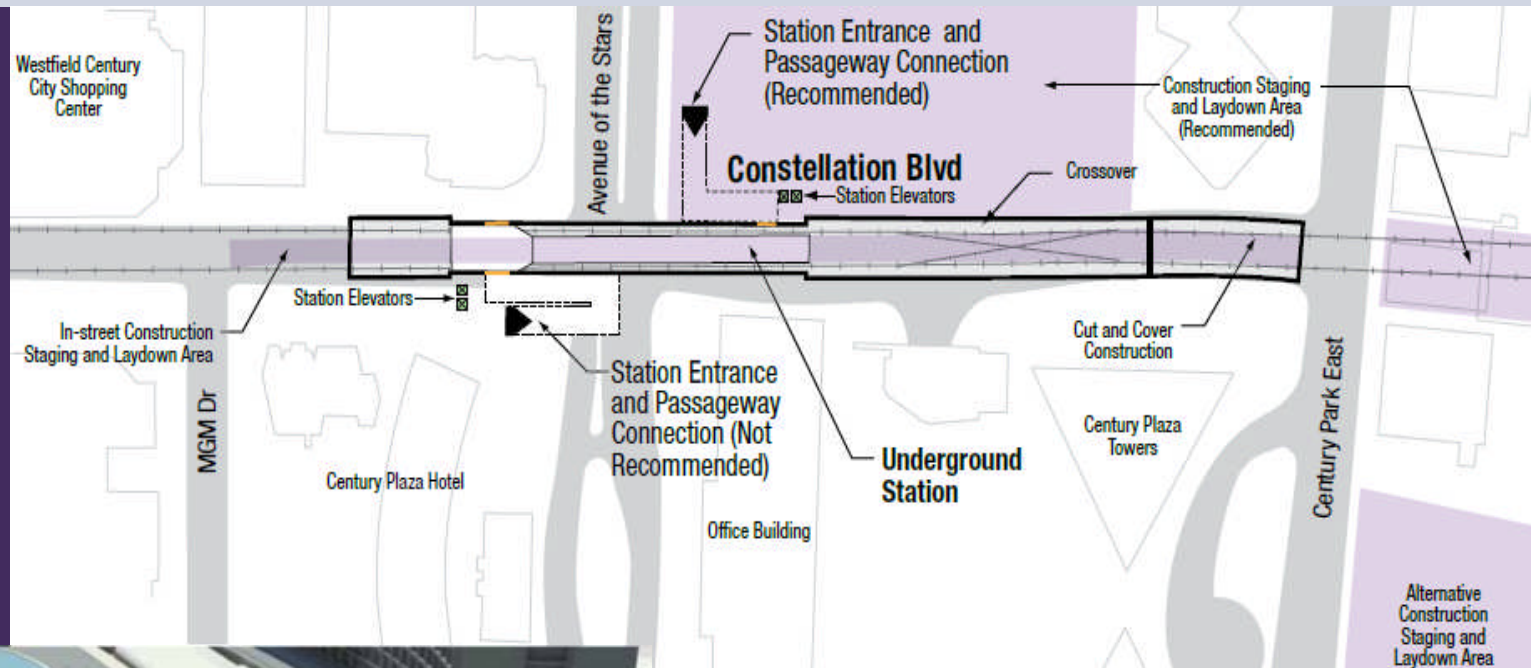

- Recommended entrance & construction staging at NE corner Constellation/Ave of the Stars
- Alternate entrance on SW corner and alternate construction sites along Century Park East

2b) Century City Station

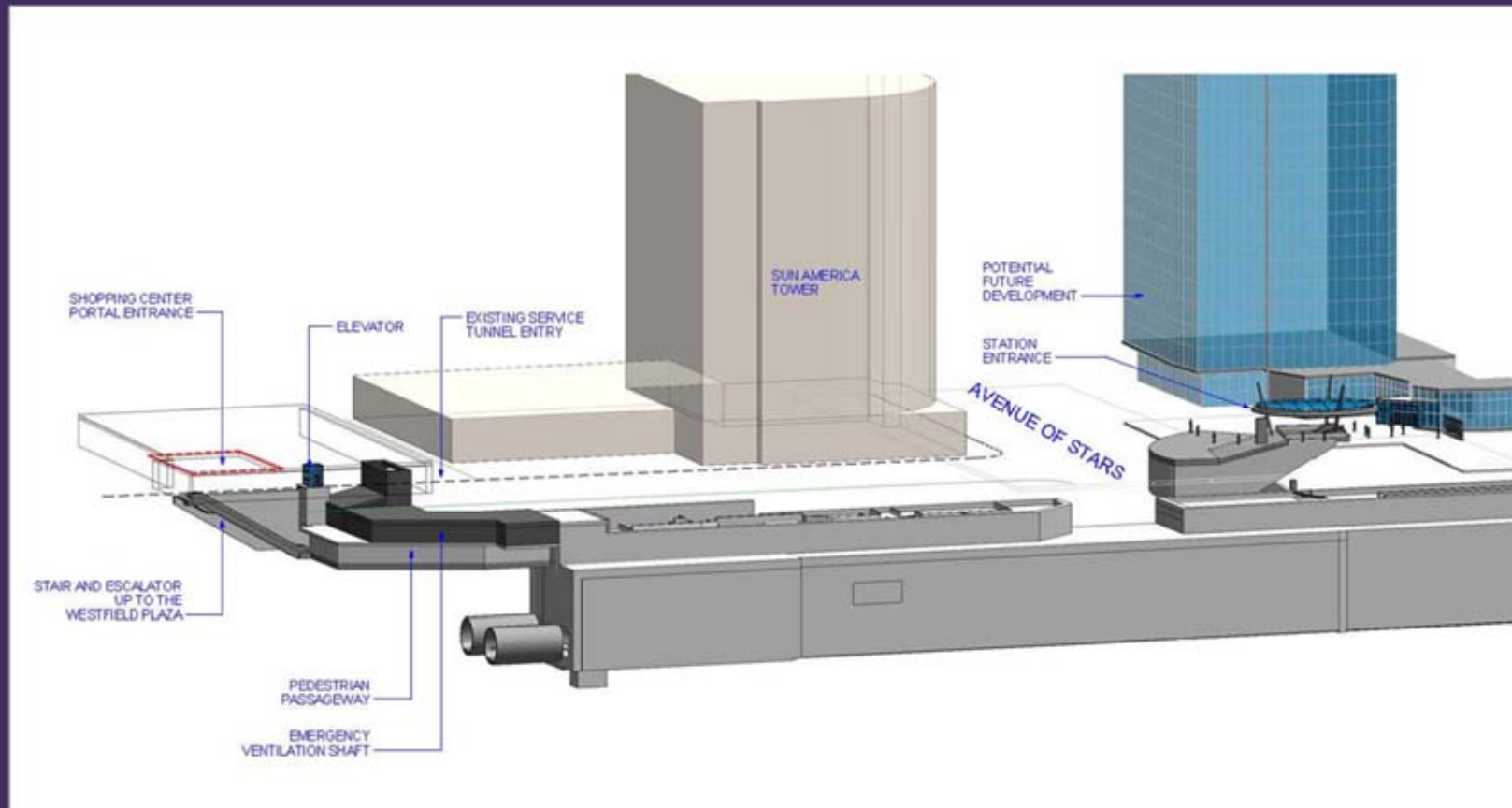

- Working to provide direct pedestrian access way to Century City Mall, including obtaining any necessary easements, at no increase in project cost
- Site specific construction mitigations, including acoustical studies at Century City Cinemas, to be developed for bid documents during final design

2c) Westwood/UCLA Station



- Recommended entrances:
 - UCLA Lot 36
 - “Split” entrance on both western corners of Wilshire/Westwood. Couldn’t fit a full entrance at any single corner
- Construction staging at UCLA Lot 36

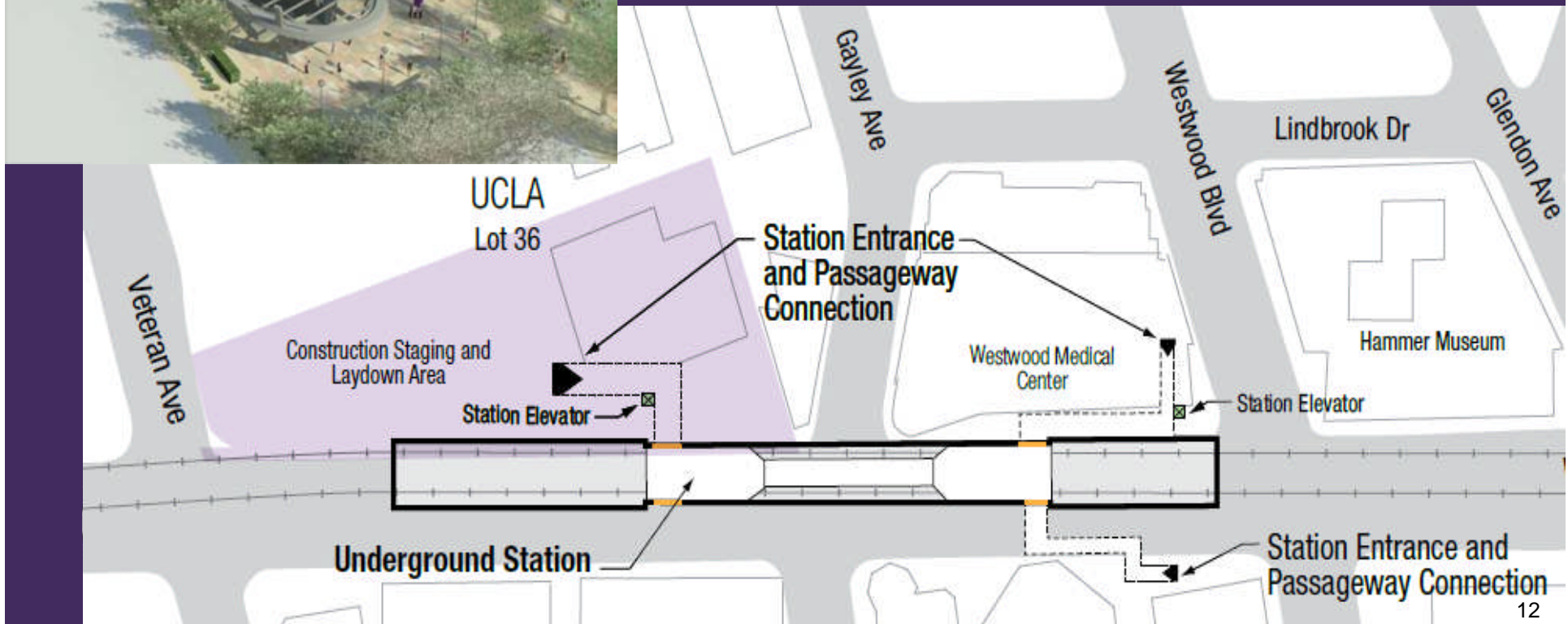

2d) Westwood/VA Hospital Station

- Recommended entrance at Bonsall, south side of Wilshire
- Construction staging in VA parking lot and perhaps elsewhere on VA campus with replacement parking and other mitigations
- Working to improve bike & pedestrian connection and drop-off options for this station

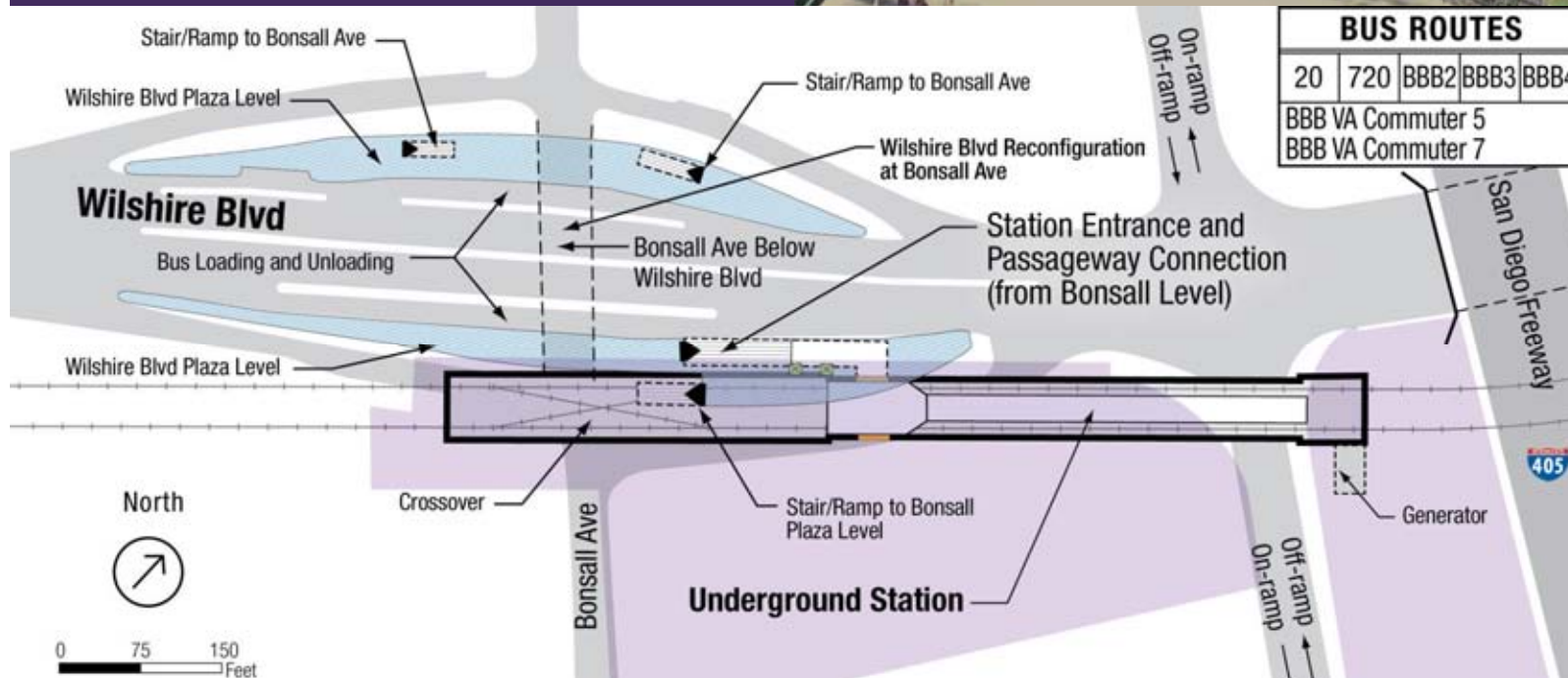

Next Steps

- **Seek Full Funding Grant Agreement (FFGA)**
- **Developing location-specific construction mitigations**
- **Continuing planning to improve access to all stations**
- **Real estate appraisals acquisitions**
- **Contracting**
- **Community outreach**
- **Field testing**